

# 605 PRESTON ROAD, CHORLEY.

NOTES:  
 1. This drawing is to be used for the purpose of planning and building control only. It is not to be used for any other purpose without the written consent of the author.  
 2. The author is not responsible for any errors or omissions in this drawing or for any consequences arising therefrom.  
 3. This drawing may not be used or reproduced without prior written consent.

Schedule	No.	
Eg	Egerton	4
Ca	Cambridge	4
Sn	Sandown	3
Cl		1
Cl	Claydon	1
N	Nelson	4
D	Dunham	2
T	Telford	1
J	Jenner	3
W	Warren	2
Oxf	Oxford	2
Da	Davey	1
Wor	Wordsworth	2
Sc	Scott	1
<b>TOTAL</b>		<b>31</b>

Rev.	Description	By	Date
B	Position of plots 5 & 6 amended. Road widened to accommodate localized parking places, indicative refuse collection points highlighted.	TGH	25/02/09
A	Plot 3 garage position amended & Oxford house type updated.	TGH	21/01/09

**mek**  
 partnership limited  
 Burnby Villa,  
 4B Watling Street Road,  
 Fulwood,  
 Preston,  
 Lancs. PR6 8BP  
 E-mail: mek@mekpartnership.co.uk  
 Web: www.mekpartnership.co.uk  
 Tel: 01772 774610 fax 01772 774811

**WAINHOMES**

Job Title  
**605 Preston Road, Chorley.**

Drawing Title  
**Site Layout** A2

Original Scale 1:500	Drawn TGH	Checked Date 19/01/09	Authorized Date
-------------------------	--------------	--------------------------	--------------------

09/00150/FUR

Drawing Status  
**PRELIMINARY**

Job No. <b>07-123</b>	Drawing No. <b>AL-003</b>	Rev. <b>B</b>
--------------------------	------------------------------	------------------

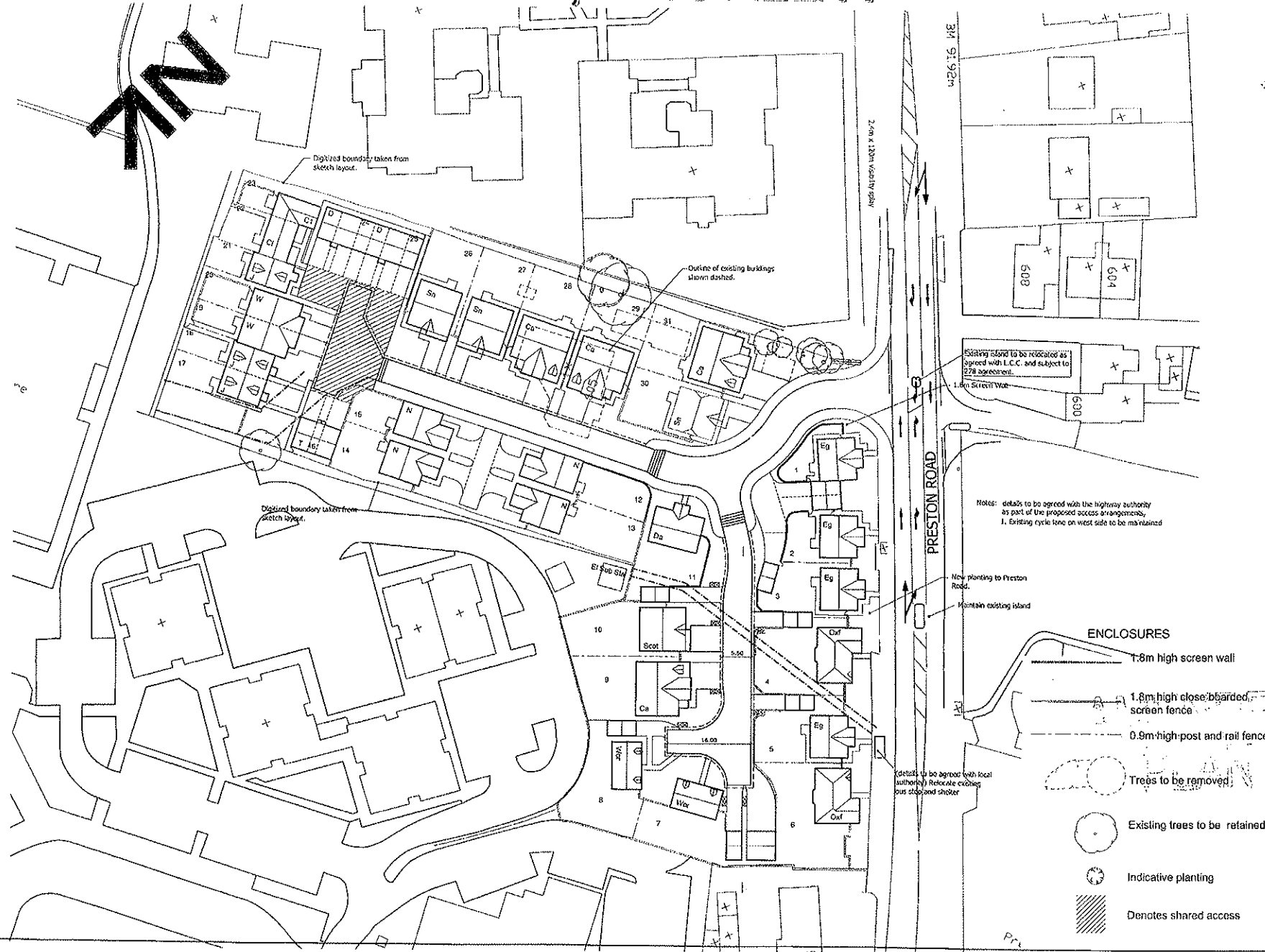

Drawn: [Name] Date: [Date] Checked: [Name] Date: [Date] Approved: [Name] Date: [Date]